

# G5W11

## 密封型防水防尘微动开关 Waterproof Micro Switch



### ■特点/Features

- ◆ 防水防尘设计，可以在会淋水或多尘埃的地方使用
  - ◆ 结构紧凑，具有微小触点间隙，快速动作、高灵敏度和微小动作行程的特点
  - ◆ 长寿命，高精度和微小动作行程的特点
  - ◆ 可在汽车、农业机械、大型家电、办公设备等有耐环境性要求的场合使用
  - ◆ 最大ENEC/UL认证电流达10A
- Water Proof and Dust Proof
  - Tight Structure, Small Contact Gap
  - Snap Action, High Sensitivity
  - Long Life, high Precision and Reliability
  - Widely used in Auto, Agricultural Equipment, Applications, Office Equipment etc
  - Max Approved Current at ENEC/UL is 10A

### ■应用/Application

- ◆ 家用电器
  - ◆ 电子设备
  - ◆ 自动化设备
  - ◆ 汽车电子
  - ◆ 农业机械
  - ◆ 办公设备
- Home Appliances
  - Electronic Devices
  - Automatic Equipments
  - Auto Electronics
  - Agricultural Equipments
  - Office Equipments

### ■特性参数/Parameters:

额定值Rating	W1	ENEC 0.1A 48VDC, 0.1A 125/250VAC, 40T85, 5E4, $\mu$ UL 0.1A 48VDC, 0.1A 125/250VAC, T85
	W2	ENEC: 5A 48VDC, 0.1A 125/250VAC, 40T85, 5E4, $\mu$ UL: 5A 125/250VAC, 5A 30VDC T85
	W3	ENEC 10(2)A 125/250VAC, 0.5A 125VDC, 0.25A 250VDC, 40T85, $\mu, 2e4$ UL 10.1A 1/10HP 125/250VAC, 0.5A 125VDC, 0.25A 250VDC, T85
容许操作频率 Operating Frequency	电气Electrical	10~30次/分 time/min
	机械Mechanical	60次/分 times/min
接触电阻(初始值) Contact Resistance (Initial Value)	端子型with terminal type	最大50m $\Omega$ ; 50m $\Omega$ Max
	导线型with wire type	最大100m $\Omega$ ; 100m $\Omega$ Max (取决于导线的长短/Depends on the length of the wire)
绝缘电阻Insulation Resistance		在500VDC时/at 500vdc, 100M $\Omega$ Min.
抗电强度Dielectric Strength	同极端子间 Between terminals	AC 1000V 50-60Hz 1min
	端子外壳间Between terminals and housing	AC 1500V 50-60Hz 1min
保存温度Storage Temperature		-40° C~+85° C
保存湿度Strorage Humidity		85%RH Max
保护结构Protection Grade	端子型With terminal type	IEC IP67(端子部分除外exclude terminal)
	导线型With wire type	IEC IP67
防触电保护级Electric-shock safeguard grade		Class II
寿命Life	电气E-Life	2万次~10万次以上(取决于类型) 2E4~10E4 cycles(depends on P/Ns)
	机械M-Life	50万次或100万次以上(60次/分Time/min) over 500,000cycles 1,000,000cycles(60cycles/min)
单重Unit Net Weight		约7g(端子型、不带手柄) Approx. 7g(with terminals type and without lever)

**G5W11 系列防水微动开关订货指引**  
**G5W11 Series Sealed Micro Switch Instruction Ordering**

G5	W	11	E	Z
开关类别 Switch Type	温度等级 Temperature grade	额定电流 Electrical Rating	端子类别 Terminal Style	接触形式 CircuitCode
W	40T85 1EC 1P67	ENEC/CQC: Rating 1: 0.1A 48VDC, 0.1A 125/250VAC, 40T85, 5E4, μ Rating 2: 5A 125/250VAC, 5A, 30VDC, 40T85, 5E4, μ Rating 3: 10 (2) A 125/250VAC, 0.5A 125VDC, 0.25A 250VDC, 40T85, μ, 2E4  UL/CUL: Rating 1: 0.1A 48VDC, 0.1A 125/250VAC, T85 Rating 2: 5A 125/250VAC, T85 Rating 3: 10.1A 1/10HP 125/250VAC, 0.5A 125VDC, 0.25A 250VDC, T85	E	Z
			W	P
			4.70x0.5mm 0.187"x0.020" 快接端子 Quick Connect	SPDT -NO 单板单投 -常开
				C
			外接导线 (for G5W11 series only)	SPST -NC 单板单投 常闭

**说明 Description:**

G5W11(rating 2): 50gf Min. Grade  
 G5W11(rating 3): 100gf Min. Grade

200	A	01	XX
操作力（最大值）数据在不带操作柄时测得 Operating Force at pin Plunger, Max	操作柄位置 Lever Position	操作柄类型 Lever Type	特别设计代码 Special Designator
015 15gf	不带操作柄 柱式按垫 No lever Pin Plunger	不带操作柄 柱式按垫 No lever Pin Plunger	W1 W1: Rating 1 (Note:标准线长/standard wire:UL1015, 24#, 300MM) W2 W2: Rating 2 (Note:标准线长/standard wire:UL1015, 20#, 300MM) W3 W3: Rating 3 (Note:标准线长/standard wire:UL1015, 18#, 300MM)
025 25gf	A 远离柱式按垫位置 Far From Pin Plunger	01 短直柄 Short Straight Lever	
050 50gf	B 靠近柱式按垫位置 Near Pin Plunger	02 标准直柄 Std. Straight Lever	... 特殊 Special
100 100gf		03 长直柄 Long Straight Lever	
200 200gf		04 模拟滚轮手柄 Simulated Roller Lever	
		05 带滚轮手柄 Roller Lever	
		06 带长滚轮手柄 Long Roller Lever	
		... ..	
		99 特殊手柄 Special Lever	

## ◆外形尺寸和操作特性 Dimensions and Operating Characteristics

(单位/Unit:mm)

### ◆G5W11-E□□-W□



型号 Part NO	OF Max (N) (gf)	RF Min (N) (gf)	PT Max (mm)	OT Min (mm)	MD MAX (mm)	OP (mm)		
G5W11-EZ015-W□	0.30	30	0.05	5	1.6	0.8	0.4	14.7±0.5
G5W11-EZ025-W□	0.40	40	0.10	10	1.6	0.8	0.4	14.7±0.5
G5W11-EZ050-W□	0.64	65	0.15	15	1.6	0.8	0.4	14.7±0.5
G5W11-EZ100-W□	1.08	110	0.35	35	1.6	0.8	0.4	14.7±0.5
G5W11-EZ200-W□	2.06	210	0.60	60	1.6	0.8	0.4	14.7±0.5

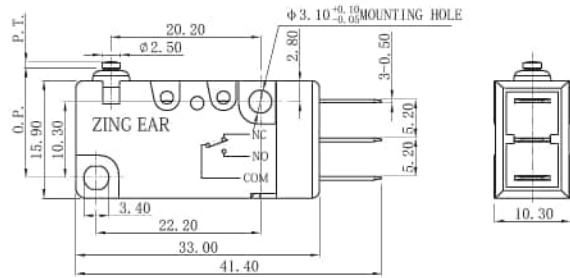

### ◆G5W11-W□□-W□



型号 Part NO	OF Max (N) (gf)	RF Min (N) (gf)	PT Max (mm)	OT Min (mm)	MD MAX (mm)	OP (mm)		
G5W11-WZ015-W□	0.30	30	0.05	5	1.6	0.8	0.4	14.7±0.5
G5W11-WZ025-W□	0.40	40	0.10	10	1.6	0.8	0.4	14.7±0.5
G5W11-WZ050-W□	0.64	65	0.15	15	1.6	0.8	0.4	14.7±0.5
G5W11-WZ100-W□	1.08	110	0.35	35	1.6	0.8	0.4	14.7±0.5
G5W11-WZ200-W□	2.06	210	0.60	60	1.6	0.8	0.4	14.7±0.5

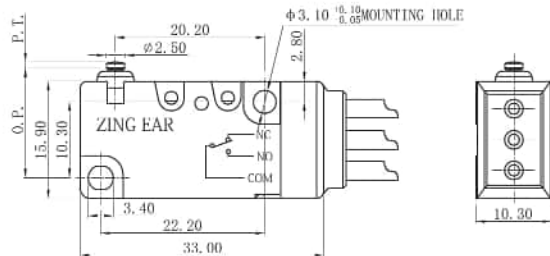

### ◆G5W11-W□□A01-W□



型号 Part NO	OF Max (N) (gf)	RF Min (N) (gf)	PT Max (mm)	OT Min (mm)	MD MAX (mm)	OP (mm)		
G5W11-WZ015A01-W□	0.30	30	0.05	5	1.6	0.8	0.4	15.3±0.5
G5W11-WZ025A01-W□	0.40	40	0.10	10	1.6	0.8	0.4	15.3±0.5
G5W11-WZ050A01-W□	0.64	65	0.15	15	1.6	0.8	0.4	15.3±0.5
G5W11-WZ100A01-W□	1.08	110	0.35	35	1.6	0.8	0.4	15.3±0.5
G5W11-WZ200A01-W□	2.06	210	0.59	60	1.6	0.8	0.4	15.3±0.5

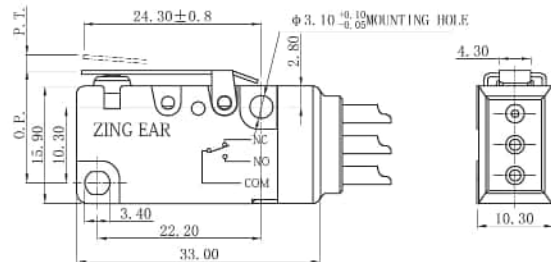

### ◆G5W11-W□□A02-W□



型号 Part NO	OF Max (N) (gf)	RF Min (N) (gf)	PT Max (mm)	OT Min (mm)	MD MAX (mm)	OP (mm)		
G5W11-WZ015A02-W□	0.20	20	0.05	5	3.2	1.3	1.2	15.3±0.5
G5W11-WZ025A02-W□	0.25	25	0.08	8	3.2	1.3	1.2	15.3±0.5
G5W11-WZ050A02-W□	0.40	40	0.15	15	3.2	1.3	1.2	15.3±0.5
G5W11-WZ100A02-W□	1.60	65	0.25	25	3.2	1.3	1.2	15.3±0.5
G5W11-WZ200A02-W□	1.27	130	0.35	35	3.2	1.3	1.2	15.3±0.5

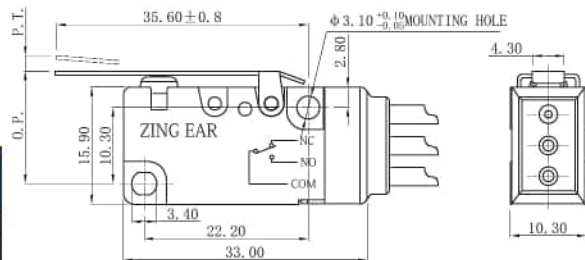

◆G5W11-W□□A03-W□



型号 Part NO	OF	RF	PT	OT	MD	OP (mm)		
	Max (N) (gf)	Min (N) (gf)	Max (mm)	Min (mm)	MAX (mm)			
G5W11-WZ015A03-W□	0.10	10	0.03	3	6.4	2.6	2.4	15.3±3
G5W11-WZ025A03-W□	0.15	15	0.05	5	6.4	2.6	2.4	15.3±3
G5W11-WZ050A03-W□	0.20	20	0.08	8	6.4	2.6	2.4	15.3±3
G5W11-WZ100A03-W□	0.35	35	0.10	10	6.4	2.6	2.4	15.3±3
G5W11-WZ200A03-W□	0.64	65	0.15	15	6.4	2.6	2.4	15.3±3

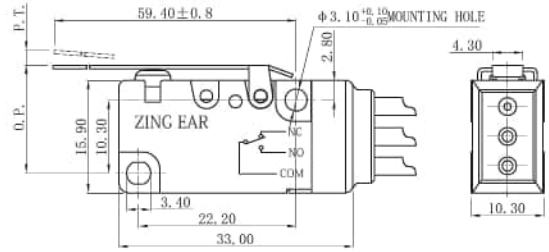

◆G5W11-W□□A04-W□



型号 Part NO	OF	RF	PT	OT	MD	OP (mm)		
	Max (N) (gf)	Min (N) (gf)	Max (mm)	Min (mm)	MAX (mm)			
G5W11-WZ015A04-W□	0.20	20	0.05	5	3.2	1.3	1.2	18.5±1.5
G5W11-WZ025A04-W□	0.25	25	0.08	8	3.2	1.3	1.2	18.5±1.5
G5W11-WZ050A04-W□	0.40	40	0.15	15	3.2	1.3	1.2	18.5±1.5
G5W11-WZ100A04-W□	0.64	65	0.25	25	3.2	1.3	1.2	18.5±1.5
G5W11-WZ200A04-W□	1.27	130	0.35	35	3.2	1.3	1.2	18.5±1.5

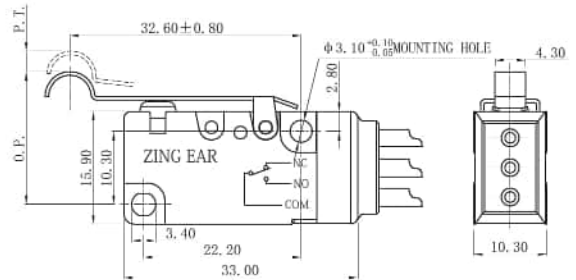

◆G5W11-W□□A05-W□



型号 Part NO	OF	RF	PT	OT	MD	OP (mm)		
	Max (N) (gf)	Min (N) (gf)	Max (mm)	Min (mm)	MAX (mm)			
G5W11-WZ015A05-W□	0.30	30	0.05	5	3.2	0.8	0.4	20.6±0.8
G5W11-WZ025A05-W□	0.40	40	0.10	10	3.2	0.8	0.4	20.6±0.8
G5W11-WZ050A05-W□	0.64	65	0.15	15	3.2	0.8	0.4	20.6±0.8
G5W11-WZ100A05-W□	1.18	120	0.35	35	3.2	0.8	0.4	20.6±0.8
G5W11-WZ200A05-W□	2.35	240	0.59	60	3.2	0.8	0.4	20.6±0.8

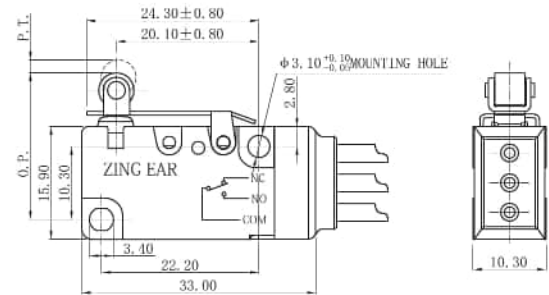

◆G5W11-W□□A06-W□



型号 Part NO	OF	RF	PT	OT	MD	OP (mm)		
	Max (N) (gf)	Min (N) (gf)	Max (mm)	Min (mm)	MAX (mm)			
G5W11-WZ015A06-W□	0.20	20	0.05	5	3.2	1.3	1.2	20.6±1.6
G5W11-WZ025A06-W□	0.25	25	0.08	8	3.2	1.3	1.2	20.6±1.6
G5W11-WZ050A06-W□	0.40	40	0.15	15	3.2	1.3	1.2	20.6±1.6
G5W11-WZ100A06-W□	0.64	65	0.25	25	3.2	1.3	1.2	20.6±1.6
G5W11-WZ200A06-W□	1.27	130	0.35	35	3.2	1.3	1.2	20.6±1.6

